

:Fabbian



*Fabbian Decorative
F25 ORU*



Company overview.

Established in 1961 in the Venetian countryside, Fabbian is one of the premier Italian lighting manufacturers operating in the modern design market, designing and manufacturing lighting fixtures for residential and commercial markets.

This history, combined with traditional Italian craftsmanship and the finest quality, keeps Fabbian a prominent brand that is internationally recognized in the architectural and design communities worldwide.

Company overview.

The endless research on new materials, trends, and aesthetics has always been combined with market demands and new business opportunities.

From the very beginning to the design application, the product life cycle is strictly controlled to make sure that each light fixture meets the highest quality expectations and safety requirements.

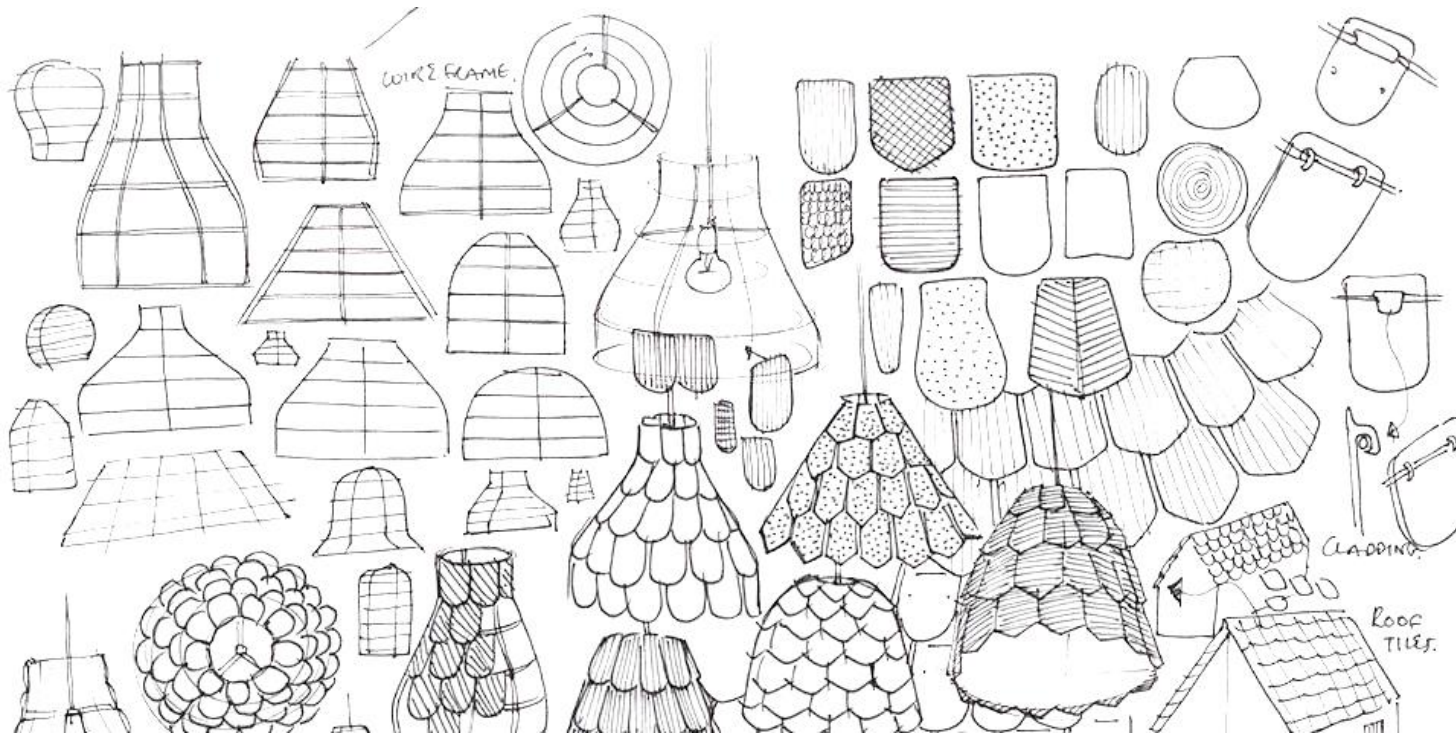

These components give Fabbian products a vast and diversified array of inspirations and styles, which is also ensured by yearly prestigious collaborations with well-renowned and emerging designers.



North America.

With over 20 years in North America, Fabbian USA offices are located in the world's capital of design, **New York City**, just blocks from Time Square.

COMPANY PROFILE

Company structure.

Proudly headquartered in Castelmimo di Resana, in the **Venetian Countryside**, the company has an international outreach.

From **Venice**, it manages directly the European region, while it distributes the products through agents or importers in the other macro-geographical areas (Greater China, Russia, South and East Asia, South America, GCC countries, Northern Africa).



Designers.

Fabbian has collaborated with some of the most prestigious designers throughout the world to create unique elements for your home and business.



A. SAGGIA &
V. SOMMELLA



AFRA E TOSIA
SCARPA



ALBERTO APOSTOLI



ALBERTO TORSELLO



FORMFJORD



FRANCESCO
LUCCHESI



GIAMPIERO DERAÏ



GIAN PAOLO CANOVA



MATALI CRASSET



MATHIEU
LEHANNUR



NICOLA DESIGN



NICOLA GARDIN-
ROGER ZANON



ALESSANDRA
BALDERESCHI



ALI SIAHVOSHI



BARTEK MEJOR



BENJAMIN HUBERT



GIGI ROSSI



GIO MINELLI



GUILLAUME
DELVIGNE



J. DELLA FONTANA
DZU



PAMIO DESIGN



PAOLO DE LUCCHI



PELLEGRINI+MENGATI
DESIGN



PIOSTITO TOSO



BRIDGEWELL
CONSULTING LTD



CONSTANCE GUISSSET



D. SUSATO &
G. CICCARESE



DESIGNZAGATO



KARIM RASHID



LAGANJA DESIGN



LORENZO TRUANI



LUCA SCACCHETTI



PROSPERO RASULO



RENATO MONTAGNER



STUDIO FUTURA



TIZIANO MAFFIONE



DOMPIER&PISONI



FE DESIGN



FEDERICA BUSANI



FLYNN TALBOT



LUCIE KOLDOVA



MARC SADLER



MARY PAVIN



MASSIMO&MARZIA
SACCONI



VIM & VIGOR



VITTORIO MASSIMO

Trade Shows & Events.

Fabbian takes part in the world's most relevant trade show dedicated to light, EUROLUCE, in Milan, every two years, with a massive booth to showcase new collections and best seller products. Other important dates in the Fabbian's calendar are Stockholm Furniture & Light Fair, WantedDesign Manhattan, and Sleep London.



FABBIAN BREADTH OF LINE

FABBIAN CUSTOM

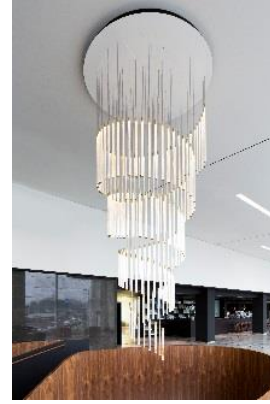

Customizable &
Unique Art & Large
scale products

Client Specific
Custom Fixture
Development

FABBIAN DECORATIVE

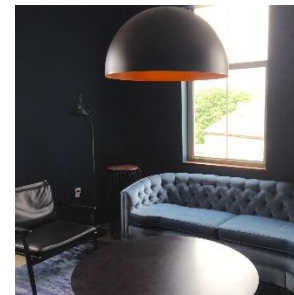

Both Glass and Non-
Glass Feature
Elements.

Varying Styles,
uniquely Italian for
the specified project

FABBIAN TECH



Italian Architectural
Downlights, Linear, &
Systems

F25 ORU

The F25 Oru Collection, designed by Vim & Vigor, is a collection of pendants that reflect an original interpretation of metal. Metal lamps are generally symmetric, but Oru is not. The distinctive side cut-out allows the shade to be bent and fixed in its new form. The result is a lampshade which appears to have a typical symmetrical shape when seen from an angle, but when viewed from another, the hole and slim organic shape can be noticed.

The designers wanted to pay tribute to the art of metal bending and produced a lampshade design which celebrates the artisan trade, but with an automatic scalability for the switch to mass production.



F25 ORU

The Oru collection is made up of two types of pendants for indoor use. The first, with an asymmetric shape and a distinctive hole, is in folded metal (offered in two sizes). The second, the luxury version launched in 2014, with its elegant, exquisite design, is a semi-spherical shade in copper.

F25 Oru pendants are perfect for both residential and commercial installations. The asymmetric pendants provide a sophisticated pop of color, while the copper version adds an air of luxury.



F25 ORU - Concept

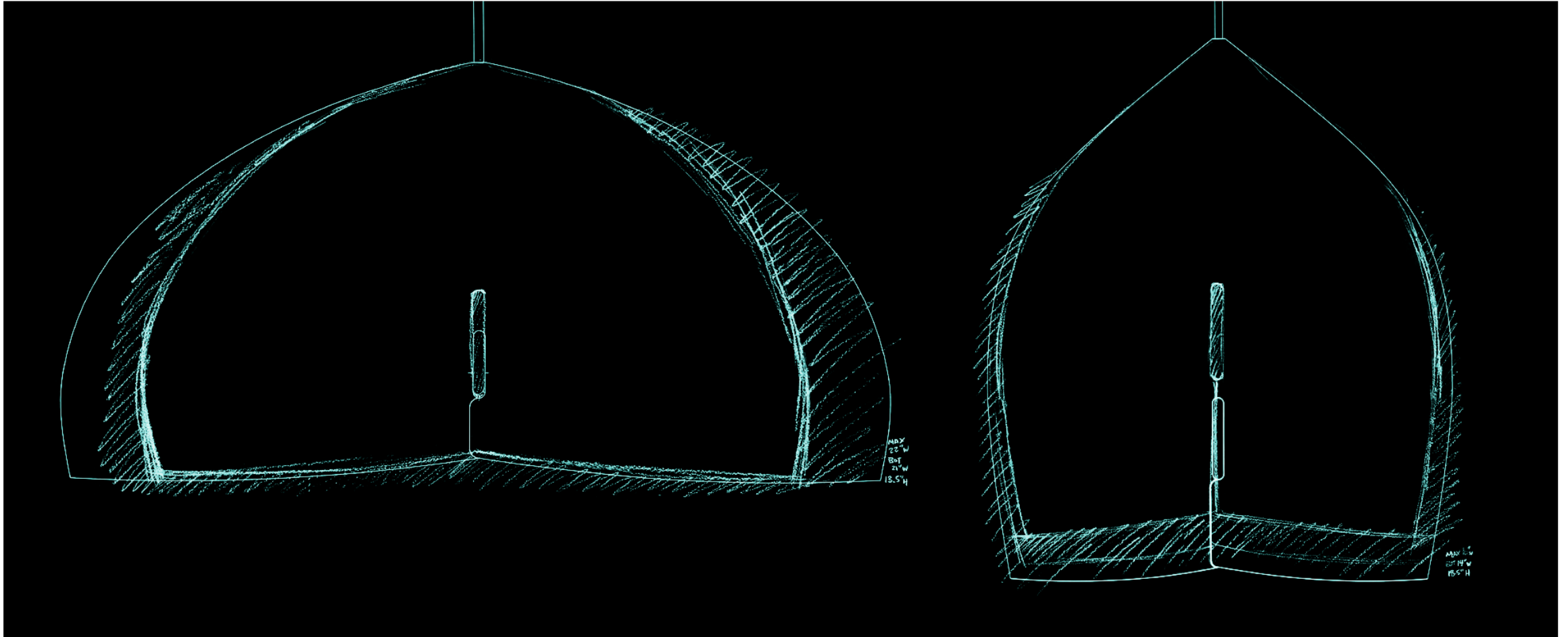

The Oru Collection was originally designed for the ICFF Studio/Bernhardt design competition for ICFF 2012. In doing so, the designers wanted to create something truly unique, and not just style another piece of furniture or lighting. They have always had a true connection to the idea and mantra behind origami. There is something quite magical to take an ordinary flat sheet of paper and then form it into something completely different yet beautiful.

F25 ORU - Concept

After many days of traditional brainstorming and concepting, we were a bit stuck with “designer’s block”. Whilst browsing some research imagery, I came upon an image of a vessel with folded corners. I thought “Wouldn’t it be really interesting to combine the cutting/folding technique with a traditional spun metal shape?” All our eyes immediately widened as we knew this was the right direction. It seemed like one of those ideas that come to you while you are in the shower or you just wake up with a light bulb above your head. A true “aha” moment!

Running with this idea, we tackled the project with full steam beginning with research and prototyping. Once the concept was proved valid through rough prototypes, we were ready for full scale sampling. - Vim & Vigor Designers



F25 ORU - Models



Oru Copper is created from a single sheet of copper that is hammered by hand into its 31" shape over a domed wooden mold. The artisan's hammering marks are visible on the unfinished exterior making a uniquely personalized pattern on each fixture. The inside of the pendant is polished to a smooth finish to reflect the light source within the fixture. With the introduction of an integral LED source into this classic precious design, efficiency blends with luxury symbiotically.

The half-dome design is a classic form that serves the residential and commercial markets. The LED version will help you meet energy budgets without sacrificing style. The array of LEDs sits at the top inside of the dome and includes a diffuser to offer a clean appearance and shield the direct view of the diodes.

F25 ORU - Models

Pendants - Luxury Copper

Pendant light for direct ambient illumination. Made in a single piece of spun copper, burnished on the outside and polished on the inside, uncoated to naturally patina. . Incandescent or LED light source. LED array includes diffuser to shield direct view of the diodes. Black (incandescent) or clear (LED) cord with copper canopy.

Lamp Type:

- F25 A07A 41: 3 x 150W E26 120V Incandescent, LED or CFL
- F25 A08A 41: 27.8W 120-277(V) Voltage 120° beam 3800 lumens, 3000K, CRI >90; dimmable 0-10V

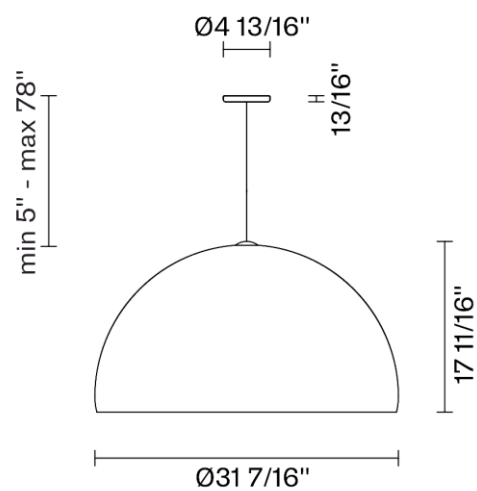

Incandescent

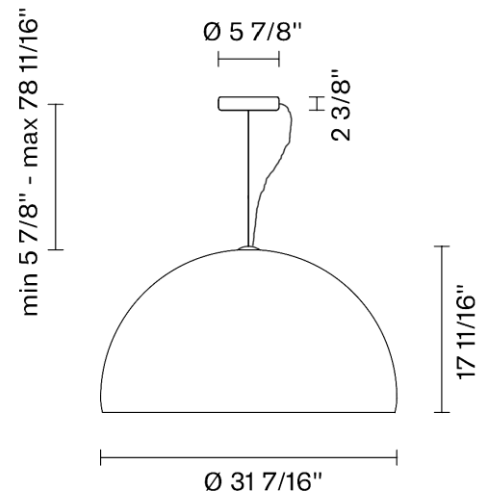

LED



F25 ORU - Technical Details

Copper LED

LED Array with diffuser
27.8W 120° beam
120-277(V) Voltage
3800 lumens
3000K
CRI >90
Dimmable 0-10V



F25 ORU - Technical Details

Copper LED



120-277(V) Voltage Dimmable 0-10V Driver located in the canopy

F25 ORU - Installation Details

Copper LED

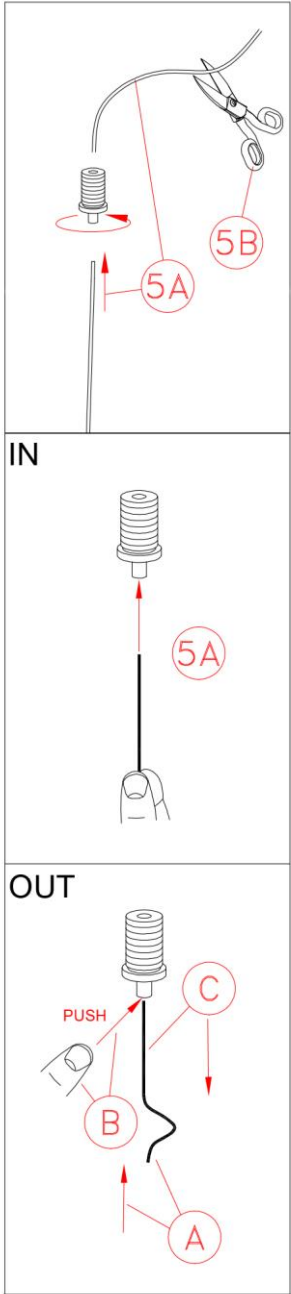
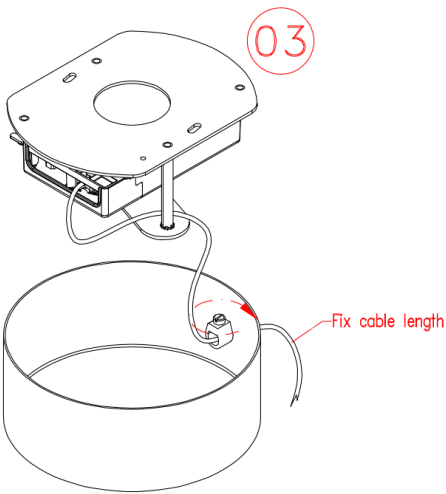
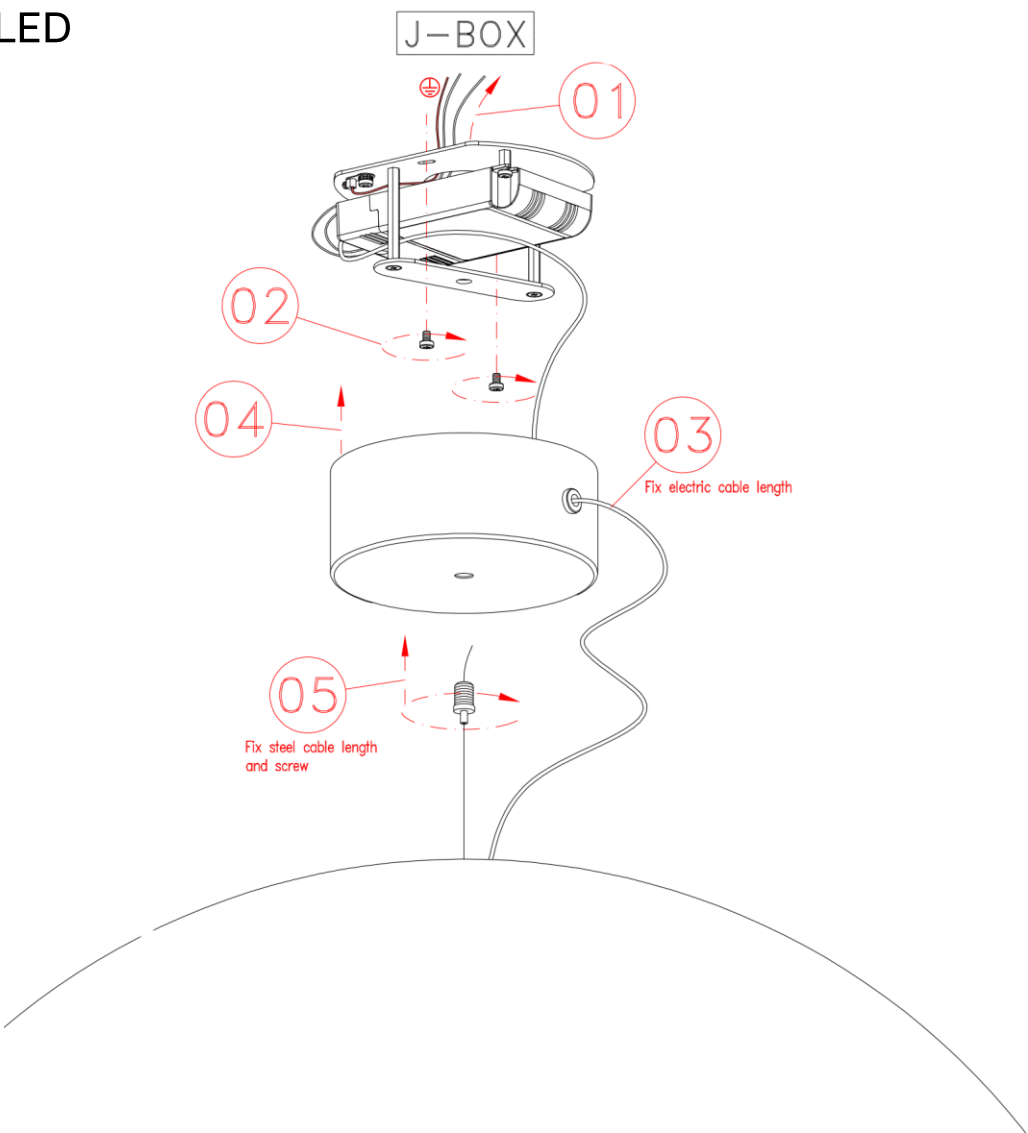

F25 ORU - Installation Details

Copper Incandescent

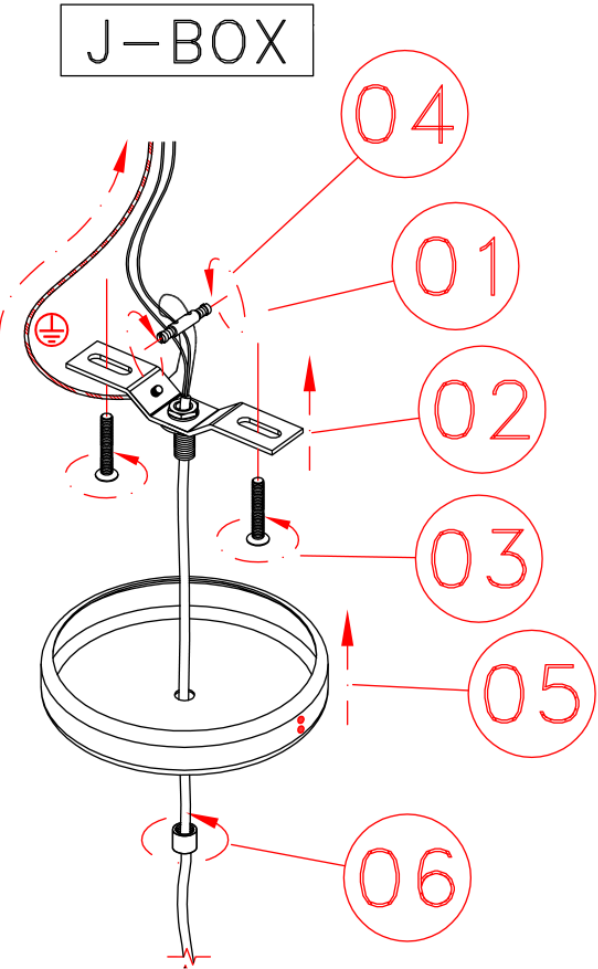
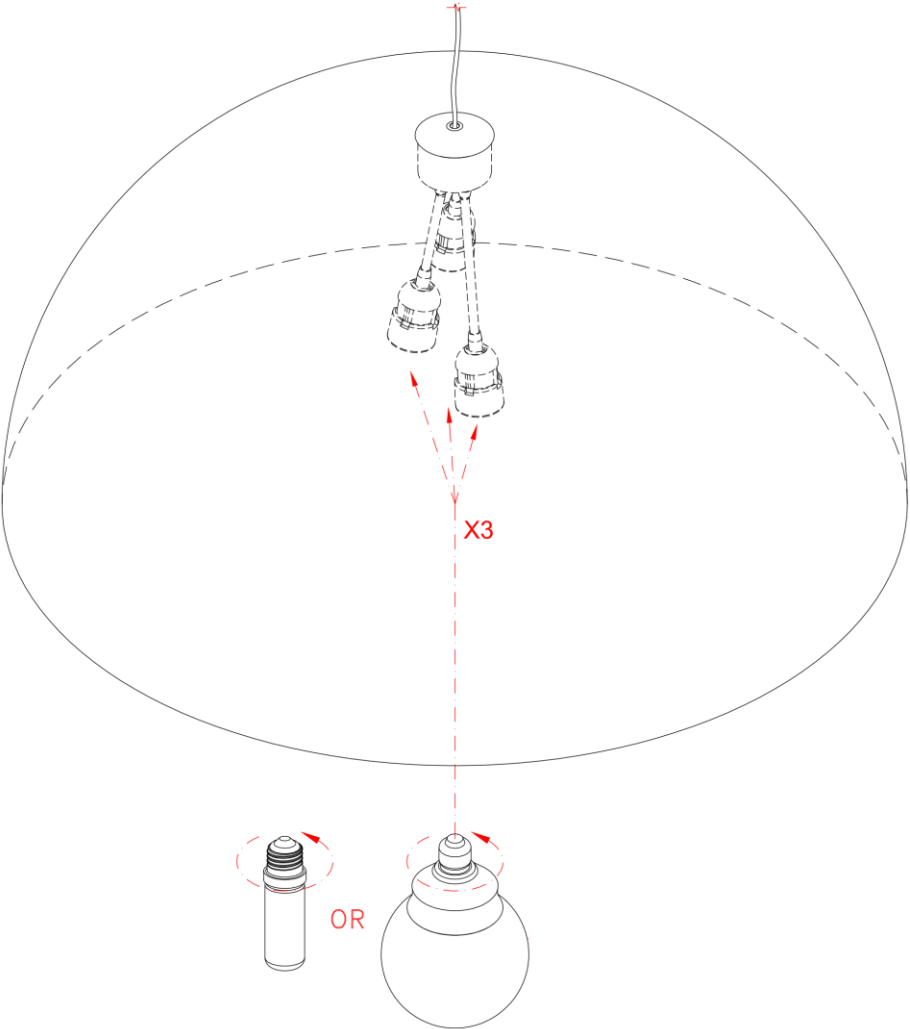



**The Home Depot
Training Center**

—

Atlanta, GA

Gensler - Atlanta







PillPack Headquarters

–

Somerville, MA

Haley McLane Design



Park Avenue

New York, NY

*Architect,
Design42
Interiors, Studio
Mellone*

F25 ORU - Models



The F25 Oru Asymmetric pendants feature the distinctive cutout that creates the asymmetric shape of the shade. Looking straight on the pendants look like typical round shades, from the side the cut out appears along with its slim organic shape.

The asymmetric pendants have a matte black painted exterior finish with red, green or teal blue on the inside. Black cord and canopy.

F25 ORU - Models

Pendants - 14.75"

Pendant light for direct ambient illumination. Spun and folded metal shade with cut outs. Matte black exterior with choice of vibrant color interior. Black cord and canopy.

TRIAC Dimming (when dimmable lamp is selected)

Lamp Type:

- 1 x 150W E26 120V Incandescent, LED or CFL

Model Numbers

F25 A01A 03 – Red

F25 A01A 43 – Green

F25 A01A 73 – Teal Blue

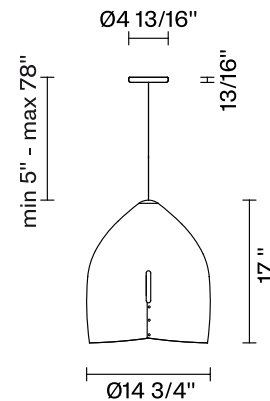

F25 ORU - Models

Pendants - 22"

Pendant light for direct ambient illumination. Spun metal shade with cut outs. Matte black exterior with choice of vibrant color interior. Black cord and canopy.

TRIAC Dimming (when dimmable lamp is selected)

Lamp Type:

- 1 x 150W E26 120V Incandescent, LED or CFL

Model Numbers

F25 A03A 03 – Red

F25 A03A 43 – Green

F25 A03A 73 – Teal Blue

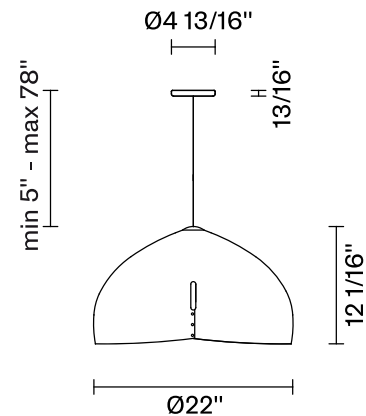

F25 ORU - Installation Details

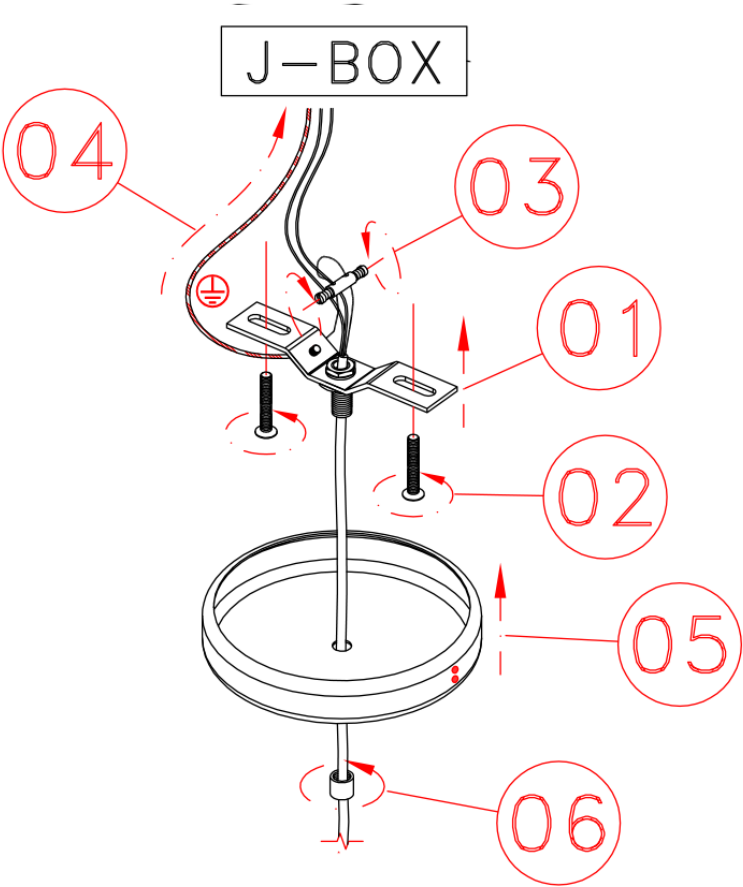
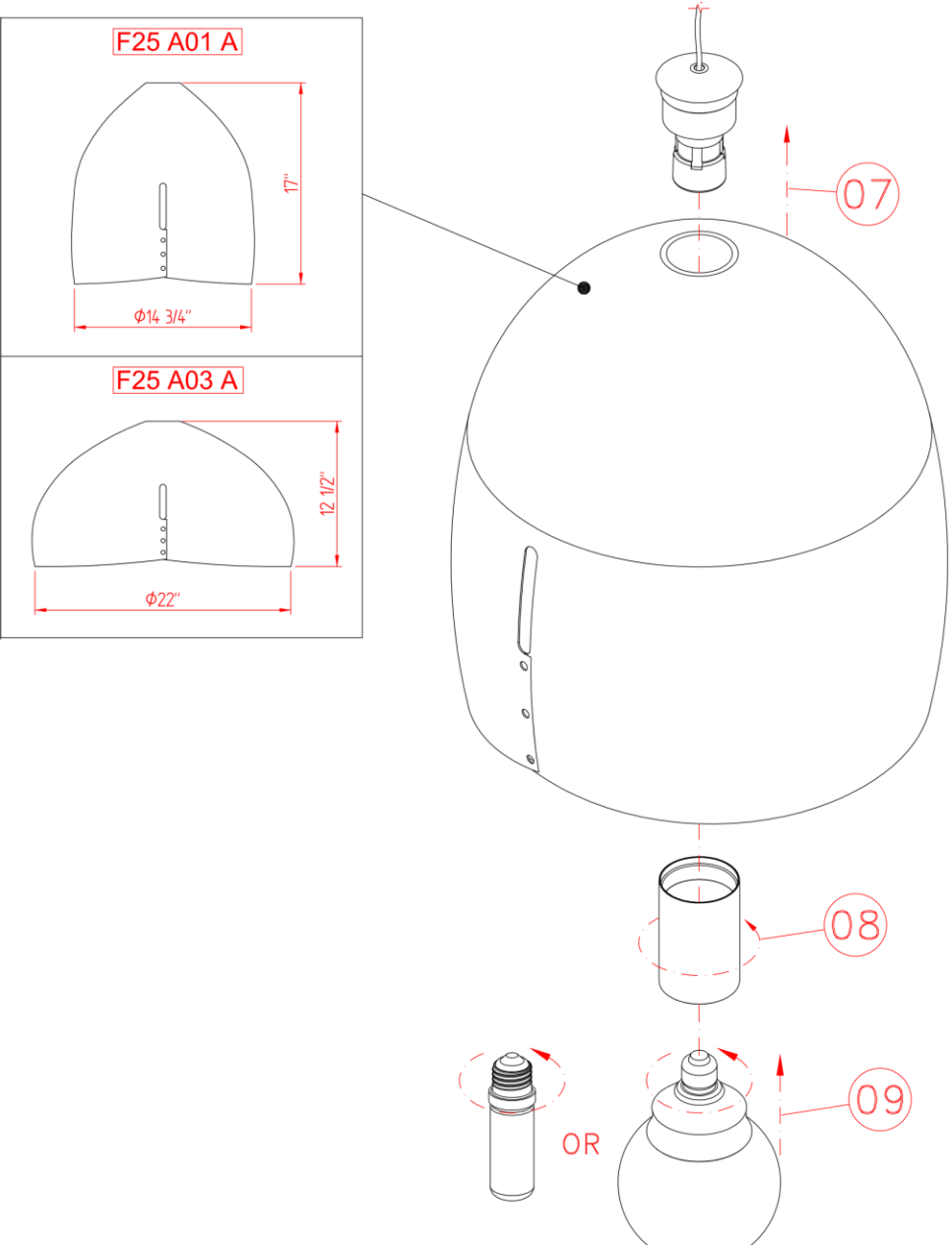



Momentum Solar Space

–
Metuchen, New Jersey

The Aztec Corporation/Aztec Architects LLC

F25 Oru









F25 Oru- Custom

Custom Possibilities:

- Custom coloring - choose from RAL, NCS or Pantone colors (pricing is dependent on quantity)
- Custom sizes - smaller sizes of the pendant are offered



Choose from RAL, NCS and Pantone colors.

Bacardi Headquarters
Custom color Copper Oru





For more information contact:
Fabbian USA

www.fabbian.us
307 W38th St. Ste 1103
New York, NY 10018 USA
sales@fabbian.com

Fabbian